

# 1 The box contains:

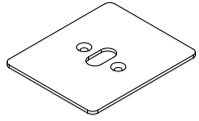

MAIN TUBE E060MC x 2



TOP PLATE E061MC x 2

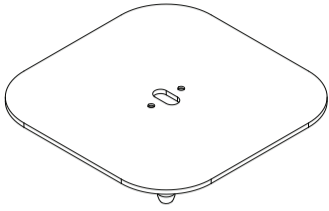

BASE PLATE E062MC x 2



BAG E063MC x 2



SPIKE E066MC x 8

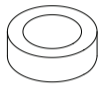

FLOOR PROTECTOR E067MC x 8

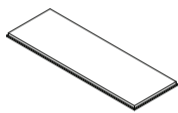

VELCRO PAD F305 x 8



FOAM GASKET E837AP x 2



M8 NUT x 8

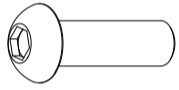

M6 BUTTON HEAD SCREW x 4

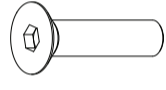

M6 COUNTERSUNK SCREW x 4



KEY E068MC x 1

# 2 BASE PLATE & SPIKE FITTING

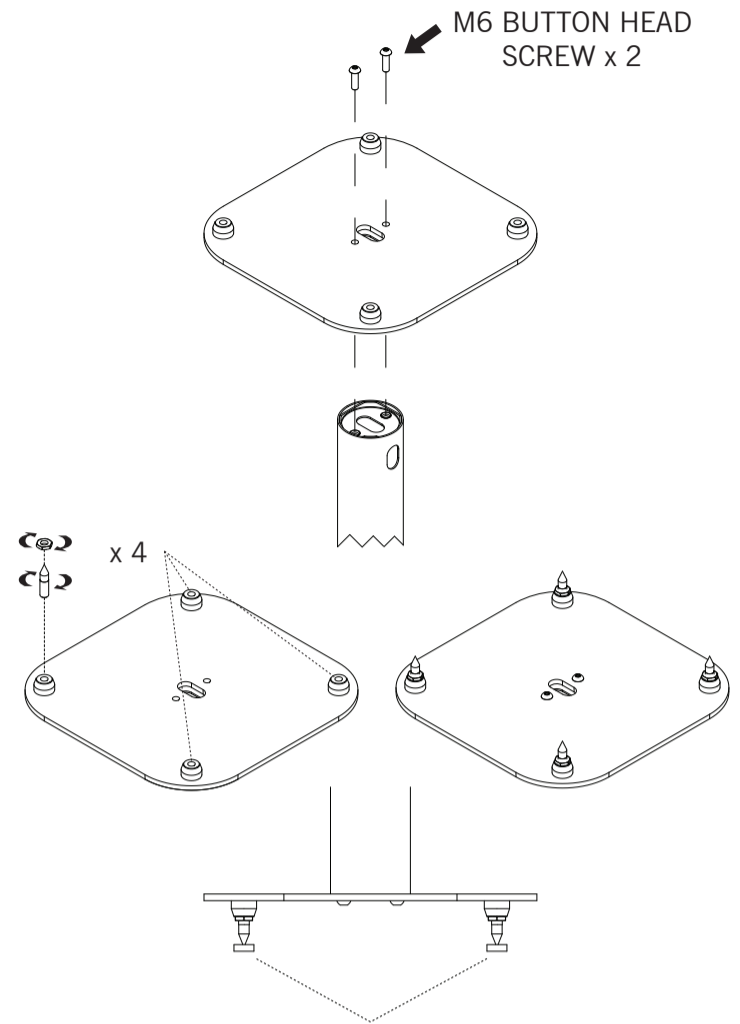

USE E067MC IF YOU WANT TO PROTECT YOUR FLOOR

# 3 CABLE ROUTING

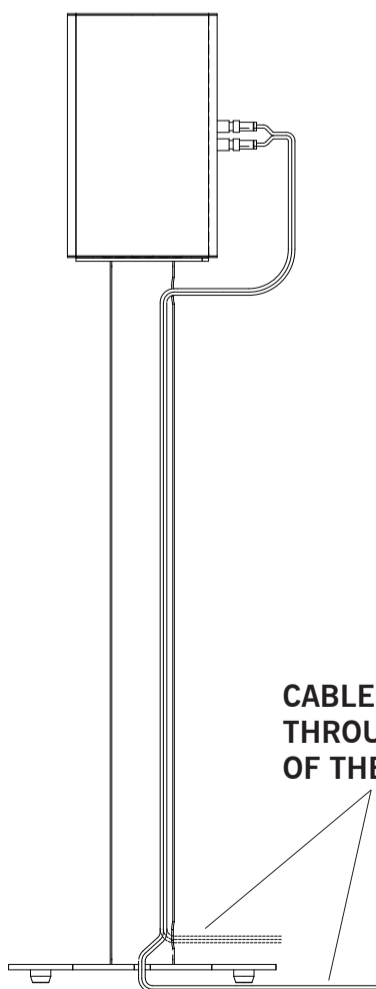

CABLE CAN BE ROUTED THROUGH THE BOTTOM OF THE TUBE OR PLATE

# 4 STABILITY & SOUND IMPROVEMENT

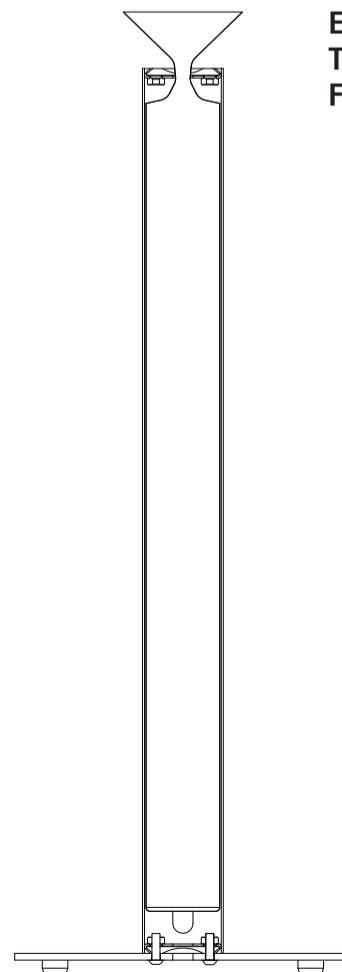

IF YOU WISH TO FILL YOUR STANDS WITH SAND, FEED E063MC THROUGH THE TOP OF THE TUBE AND FILL.

5

## TOP PLATE FITTING

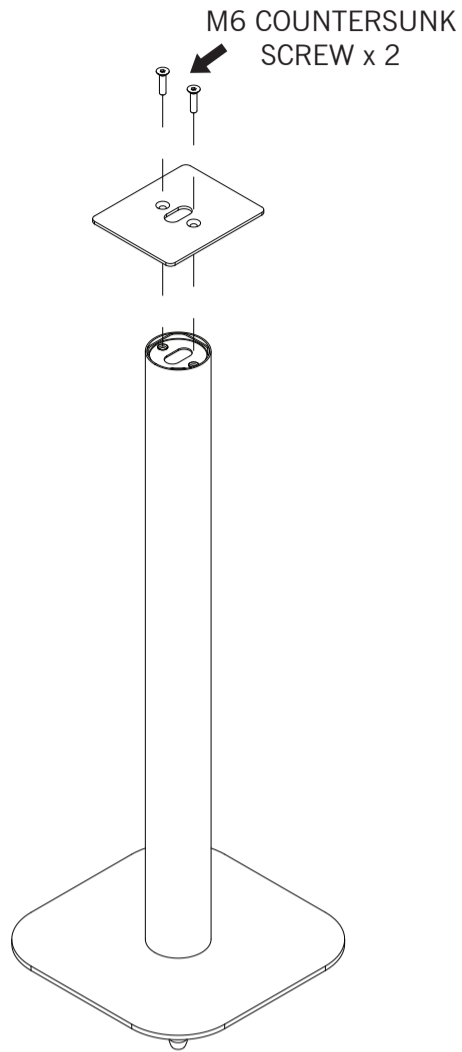

# Muso Speaker Stand Assembly Instructions

## ARCAM

A & R Cambridge Ltd, Pembroke Avenue, Waterbeach,  
CAMBRIDGE CB25 9QR, England

SH203E  
Issue A

6

## SECURING MUSO SPEAKER

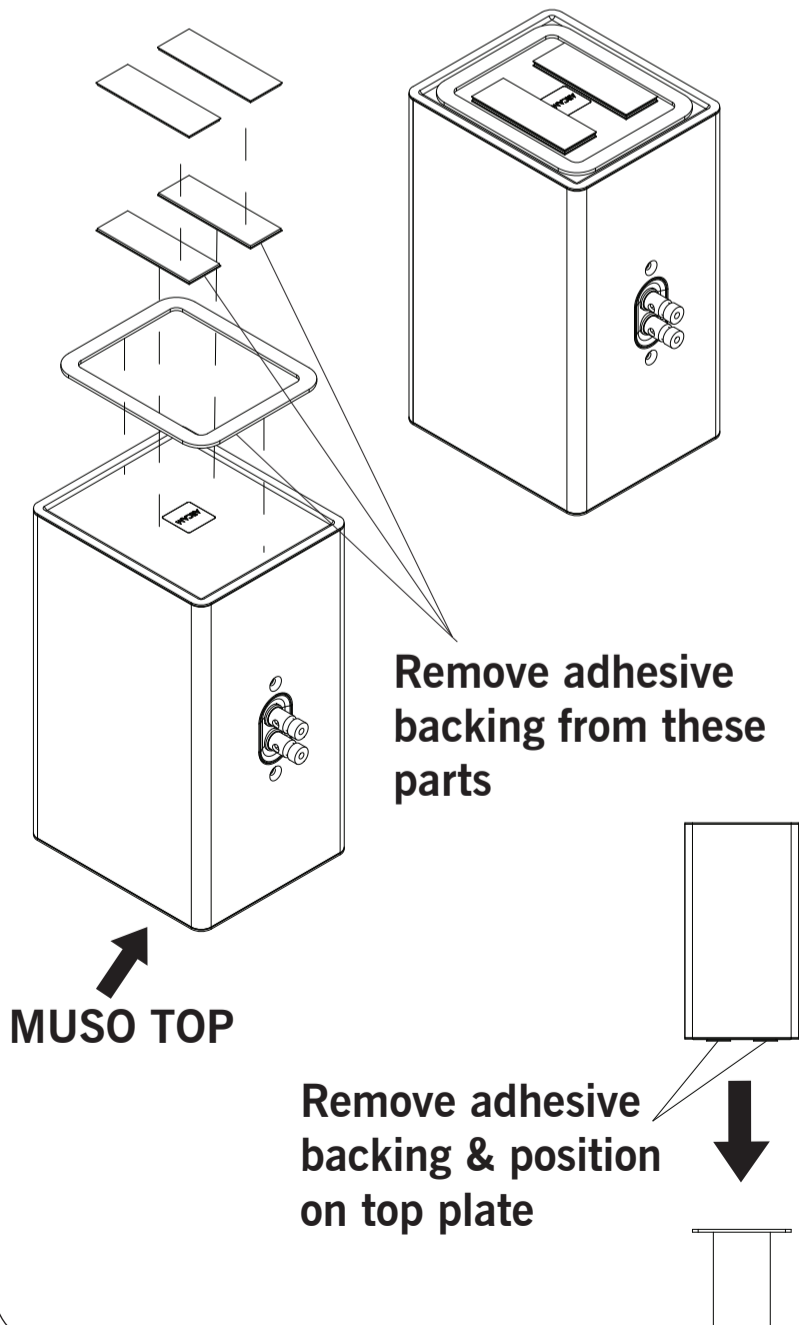

7

## NOTICE TO PURCHASER

Dear ARCAM customer,

Thank you for purchasing these Muso Speaker Stands. Please note that these have been designed exclusively to support ARCAM Muso Speakers. ARCAM will replace any parts of this product which are found to be defective within one year of purchase, provided they have been used in accordance with the fitting instructions.

ARCAM disclaims liability for any damage caused when using any other speakers, or if the stands are not assembled in accordance with the instructions. ARCAM, its distributor and their respective agents cannot be held liable or responsible for property damage or injuries, direct, indirect or consequential, due to the use, or inability to use this product safely and correctly.

We have endeavored to produce an accurate and concise assembly guide. ARCAM disclaims liability for any problems arising from the interpretation of information within this guide.

## ARCAM

www.arcam.co.uk